

CMA51/52 Relay



CMA51Relay

1.COILDATA

1-1.NominalVoltage	6to12VDC
1-2.CoilResistance	RefertoTable1
1-3.OperateVoltage	RefertoTable1
1-4.ReleaseVoltage	RefertoTable1
1-5.NominalPowerConsumption	0.6/0.8W

2.CONTACTDATA

2-1.ContactArrangement	1FormC,1FormA
2-2.ContactMaterial	Silver-Tinoxideindium
2-3.ContactRating	20A14VDC LockedMotorLoad 15A14VDC Resistive
2-4.Max.SwitchingVoltage	16VDC
2-5.Max.CarryingCurrent	35A/10min.25A/1Hr
2-6.Max.SwitchingLoad	35A
2-7.Max.InrushCurrent	60A
2-8.Min.SwitchingLoad	6VDC1A
2-9.ContactResistance(Initial)	50m .at6VDC1A
2-10.LifeExpectancy	
Electrical	200,000operations
Mechanical	10,000,000operations

3.GENERALDATA

3-1.InsulationResistance	Min.100M at500VDC
3-2.DielectricStrength	500VAC,1minbetweenopencontacts 500VAC,1minbetweencontactsandcoil
3-3.OperateTime	Max.10ms
3-4.ReleaseTime	Max.10ms
3-5.TemperatureRange	-30to+85°C
3-6.ShockResistance	10G
3-7.VibrationResistance	10-55Hz,Amplitude1.5mm
3-8.Weight	6gr

4.DIMENSIONS(inmm)

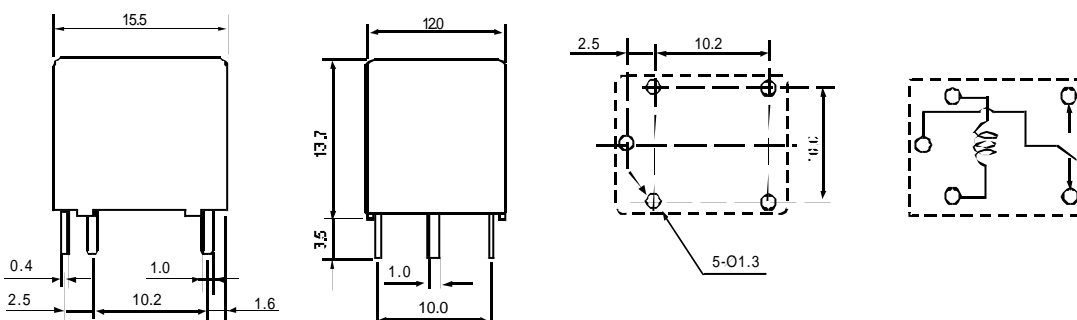

5.ORDERINGCODE

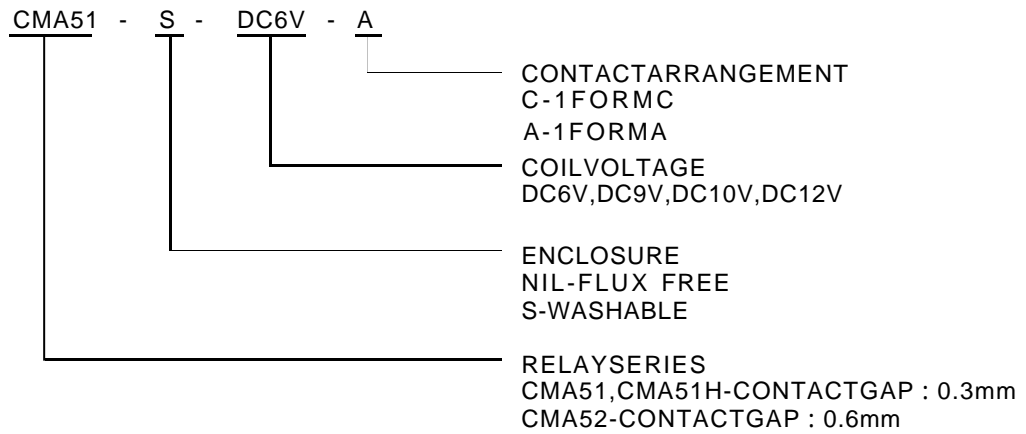

6.COILDATACHART

at 20°C

ORDERINGCODE	COIL VOLTAGE VDC	COIL RESISTANCE +/-10%	OPERATE VOLTAGE VDC	RELEASE VOLTAGE VDC	POWER CONSUMPTION mW
CMA51H-(S)-DC6V	6	60	3.6	0.6	600
CMA51H-(S)-DC9V	9	135	5.4	0.9	
CMA51H-(S)-DC10V	10	180	6.0	1.0	
CMA51H-(S)-DC12V	12	240	7.2	1.2	
CMA51/52-(S)-DC6V	6	45	3.6	0.6	800
CMA51/52-(S)-DC9V	9	100	5.4	0.9	
CMA51/52-(S)-DC10V	10	135	6.0	1.0	
CMA51/52-(S)-DC12V	12	180	7.2	1.2	

Table1

7.CMA51/52 CHARACTERISTICDATA

MaximumCapacity
ContactSwitchingCurrent(A)

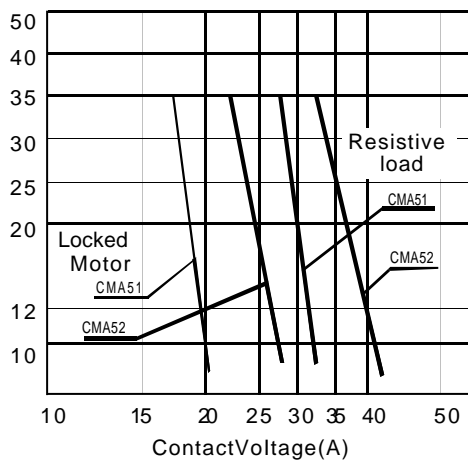

LifeCurve
Operations(x10,000)

